

#5400

RollerHook is a state of the art trellis hook. The unique design of RollerHook enables easy, efficient, and safe trellising of greenhouse tomato plants.

Each RollerHook is composed of two parts, a multi season metal frame and a disposable spool. The unique design prevents the hook from accidentally slipping off the trellis wire.

RollerHook's advantages:

- Quick and easy operation.
- Full control of plant's lowering.
- Disposable spool with up to 36 meters of UV resistant twine.
- Up to three consecutive growing cycles.
- Low-cost use.
- Suitable for 2.5 to 4.0 mm trellising wire.

Operating Instructions

A. Installing the spool

RollerHook is composed of two separate parts, the spool and the metal frame hook. To assemble RollerHook:

1. Hold the hook vertically with the locking arm (a) under your thumb. Ensure the orientation of the axle holder (b) is as illustrated. Squeeze the locking arm against the top bar.

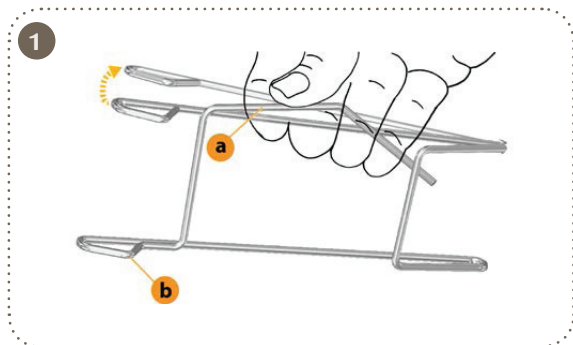

2. Place the spool axle (d) located on opposite side of the spool stopper (c) on the lower axle holder.

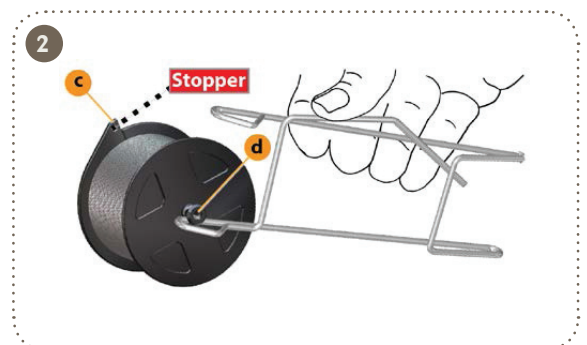

3. Turn the spool while inserting the spool axle into its holder. Turn the spool around the lower axle until the opposite axle is below the top axle holder.



4. Push the locking arm with the spool to center the axle with the axle holder and then release the top hook bar.

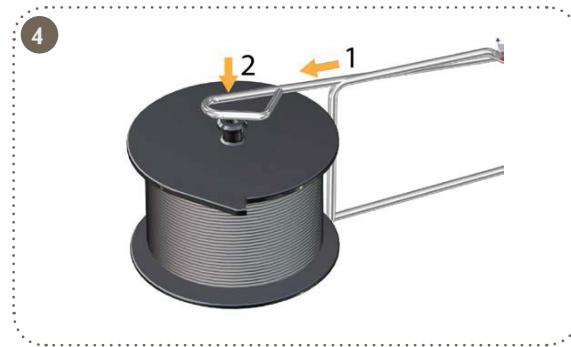

5. RollerHook is ready for operation when the two axles are inserted in their axle holders, the spool stopper is attached to the locking arm, and the twine edge is loose.



B. Installing RollerHook on the

Greenhouse Trellis Wire

Hang RollerHook on the trellis wire (b).

Verify that the locking arm (a) faces the direction in which plants will lower.

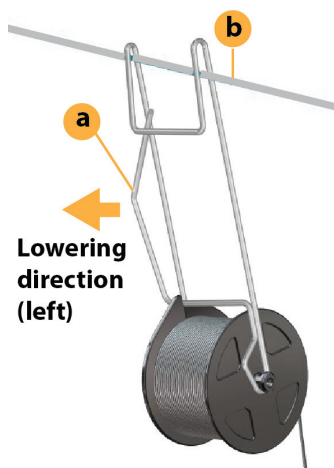

C. Routine Usage

To lower the plant:

Hold the twine in one hand.

Using the other hand, squeeze the locking arm (c) to release the stopper.

Release the twine while moving RollerHook along the trellis wire in the direction that the plant is intended to lower.

